

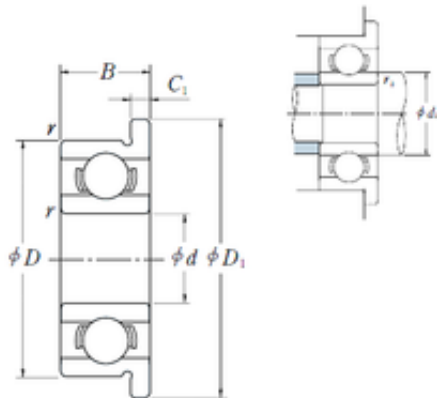

CAR Bearing manufacturing Co.,Ltd

NSK F684 deep groove ball bearings



Bearing No. F684

Size	4x10.3x2.5 mm
Bore Diameter	4 mm
Outer Diameter	10,3 mm
Width	2,5 mm
d	4 mm
D	9 mm
D1	10,3 mm
B	2,5 mm
r min. -	0,15 mm
C1	0,6 mm
da min.	4,8 mm
ra max.	0,1 mm
Weight	0,7 Kg
Basic dynamic load rating (C)	640 kN
Basic static load rating (C0)	225 kN
(Grease) Lubrication Speed	53000 r/min
SRI	0.89
hidYobi	F684
LangID	1
D_	9
SREX	0.02
C	0.64
B_	2.5
hidTable	ecat_NSESBMF
C0r	23
Oil rpm	63000

F684 Bearing 2D drawings and 3D CAD models



CAR Bearing manufacturing Co.,Ltd

SRE	0.89
mass	0.7
GRS rpm	53000
ra	0.1
SRIX	0.02
Cr	65
SRIN	0
C_1	0.6
C0	0.225
fo	12.746
SREN	0
D_1	10.3
DE_	7.938
Prod_Type3	ESM_MD_WF_OT
da	4.8
DA_	1.588
Z_	7
yobi	F684
SDM_	6.35
r	0.1
KBRG	6101
DI_	4.762
B0	2.5