

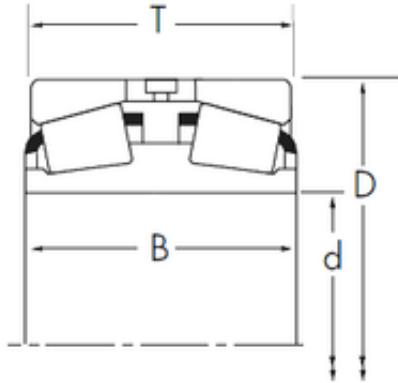

CAR Bearing manufacturing Co.,Ltd



Timken
HM262749D/HM262710+HM262710EB tapered
roller bearings

Bearing No. HM262749D/HM262710+HM262710EB

Size	346.075x488.95x174.625 mm
Bore Diameter	346,075 mm
Outer Diameter	488,95 mm
Width	174,625 mm
d	346,075 mm
D	488,95 mm
T	174,625 mm
B	174,625 mm
R	3,3 mm
r	3,3 mm

HM262749D/HM262710+HM262710EB Bearing 2D
drawings and 3D CAD models